



AIRXCEL, INC. - SUBURBAN DIVISION
676 Broadway Street
Dayton, Tennessee 37321
423-775-2131
www.AIRXCEL.com



REPLACEMENT PARTS LIST AND
PARTS ILLUSTRATIONS FOR
NAUTILUS ON DEMAND WATER HEATER
(IW60) DIRECT VENT GAS *with*
DIRECT SPARK IGNITION (5186)

**Only factory authorized parts are to be used.
Do not attempt to repair defective parts.**

When ordering repair parts from your dealer or a distributor, always give the following information:

1. Part Number (Not Item No.)
2. Part Description
3. Model No. and Serial No. of your water heater
4. Number of Parts Required



LISTE DES PIÈCES DE RECHANGE ET
ILLUSTRATIONS DES PIÈCES POUR LES
NAUTILUS ON DEMAND WATER HEATER
(IW60) GAZ À ÉVACUATION DIRECTE *avec*
ALLUMAGE DIRECT PAR ÉTINCELLE (5186)

**Seules les pièces d'usine autorisés doivent être utilisés.
Ne pas tenter de réparer les pièces défectueuses.**

Lors de la commande de pièces de rechange auprès de votre revendeur ou un distributeur, toujours donner les informations suivantes:

1. Numéro de pièce (Non Point n °)
2. Description de la pièce
3. N° de modèle et de série de votre chauffe-eau
4. Nombre de pièces nécessaires

CABINET ASSEMBLY

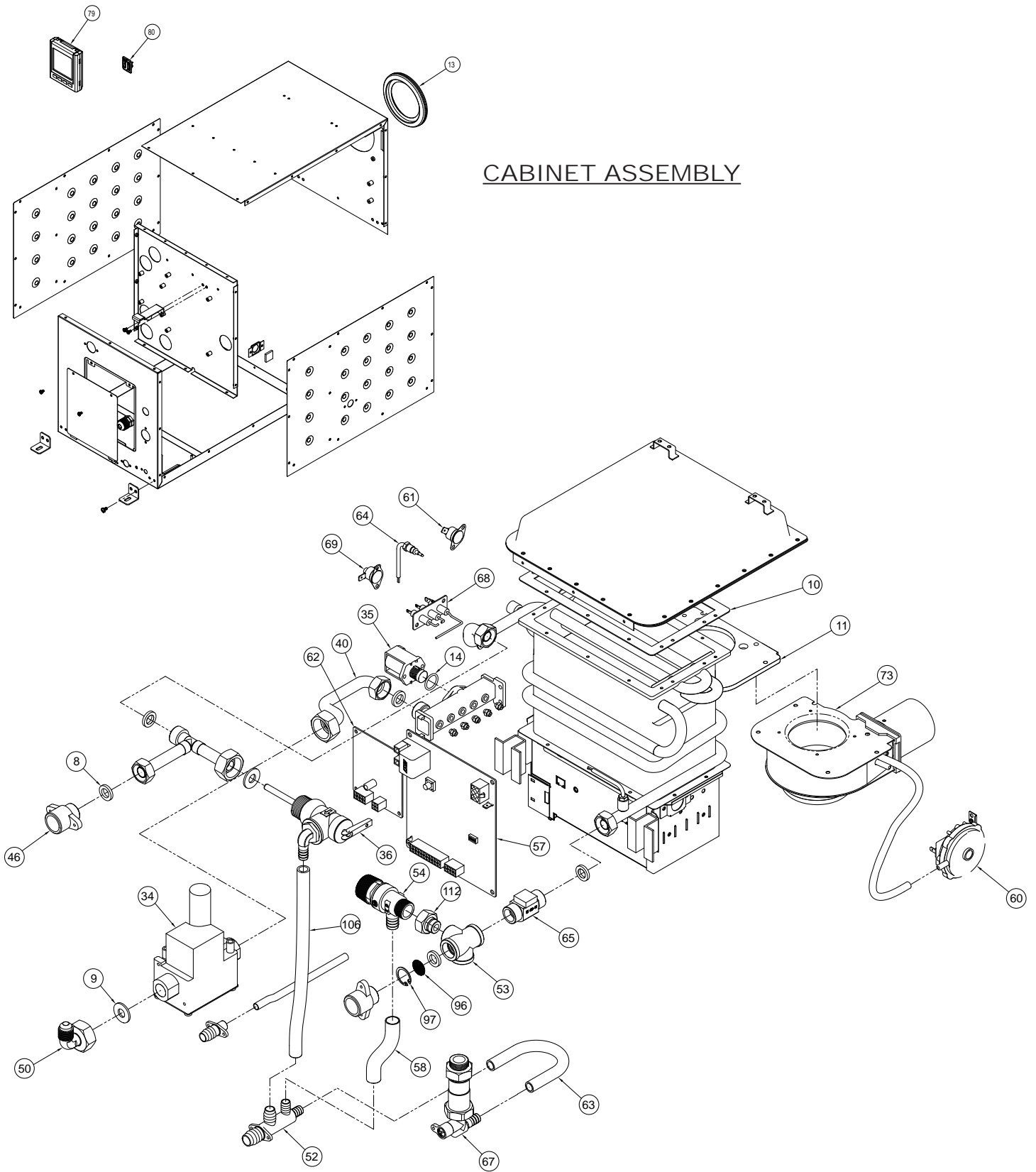

NAUTILUS PARTS ILLUSTRATION AND PARTS LIST (IW60)

8	071981	GASKET, RUBBER 1/2"	9
9	071982	GASKET, RUBBER 3/4"	2
10	071983	GASKET, HEAT EXCHANGER	1
11	071984	GASKET, BLOWER ASSEMBLY	1
13	071986	GASKET, EXHAUST CABINET	1
14	071991	GASKET, RUBBER SEALING RING	1
34	161248	VALVE, GAS DEMAND WH	1
35	161249	SOLENOID, TWO STAGE REGULATOR	1
36	161250	VALVE, PRESSURE RELIEF	1
40	172002	GAS INLET PIPE DEMAND WH	1
46	172013	FITTING, WATER DEMAND WH	2
50	172032	FITTING, GAS INLET ASSY	1
52	172020	FITTING, BRASS DRAIN	1
53	172021	FITTING, INTER 4 WAY JOINT	1
54	172022	VALVE, WATER DRAIN SHUT-OFF	1
57	521135	MODULE BOARD IW60	1
58	172026	TUBING, FLEXIBLE HOSE	1
60	233229	AIR PRESSURE SWITCH	1
61	233231	SENSOR, OVERHEAT	1
62	521136	MODULE BOARD, BLOWER CONTROLS	1
63	172025	TUBING, FROST PROTECTION DRAIN	1
64	233235	PROBE, TEMPERATURE DEMAND WH	2
65	233237	FLOW SENSOR DEMAND WH	1
67	233243	VALVE, FROST PROTECTION	1
68	233245	ELECTRODE/FLAME PROBE	1
69	233253	SWITCH, LIMIT WITH RESET	1
73	391127	BLOWER ASSY, DEMAND WH	1
79	161252	ON DEMAND CONTROL CENTER (WHITE)	A/R
79A	161253	ON DEMAND CONTROL CENTER (BLACK)	A/R
80	232589	SWITCH/LAMP & PLATE ASSY (WHITE)	A/R
80A	232795	SWITCH/LAMP & PLATE ASSY (CREAM)	A/R
80B	232229	SWITCH/LAMP & PLATE ASSY (BLACK)	A/R
96	031382	SCREEN, WATER INLET	1
97	063849	CLIP, RETAINER	1
106	172098	TUBING, T&P DRAIN	1



AIRXCEL, INC. - SUBURBAN DIVISION
676 Broadway Street | Dayton, Tennessee 37321 | 423-775-2131
www.AIRXCEL.com

This manual has been provided courtesy of
My RV Works, Inc.

www.myrvworks.com



You can find more RV service manuals here:

www.myrvworks.com/manuals

Over the years of running a mobile RV repair service, having a dedicated place to access service manuals for all the different appliances and components found on RVs was something that I always had a desire to create.

I hope this resource makes your RV repairs easier, as it has mine, but please be careful and follow proper safety practices when attempting to repair your own RV.

If in doubt, please consult with a professional RV technician!



DARREN KOEPP - OWNER, MY RV WORKS, INC.

All service manuals provided on www.myrvworks.com are believed to be released for distribution and/or in the public domain.