

SLIDE-OUTS

Part #	Controller Version	Controller Replacement	Motor(s) Used
239657	A (Daisy Chain) (Fig. 1)	A Only	Round-Square (Fig. 8), Round-Round (Fig. 9A, 9B)
211852	B (Fig. 2)	B Only	Round Square (Fig. 8)
	C (Fig. 3)	C1	Round-Round (Fig. 9A, 9B), Round-Square Plate (Fig. 10)
	C1 (Fig. 4)	C1	Round-Round (Fig. 9A, 9B), Round-Square Plate (Fig. 10)
	C2 (Fig. 5)	C2	Round-Round (Fig. 9A, 9B), Round-Square Plate (Fig. 10)
326876	8 Amp (Fig. 6)	8 Amp Only	Round-Round (Fig. 9A, 9B)

NOTE: Always replace the motor in the system with the same motor except the Round-Square Plate (Fig. 10), which is obsolete. That motor will be replaced with the Round-Round (Fig. 9A, 9B).

Fig. 1

Fig. 2

Fig. 3

Fig. 4

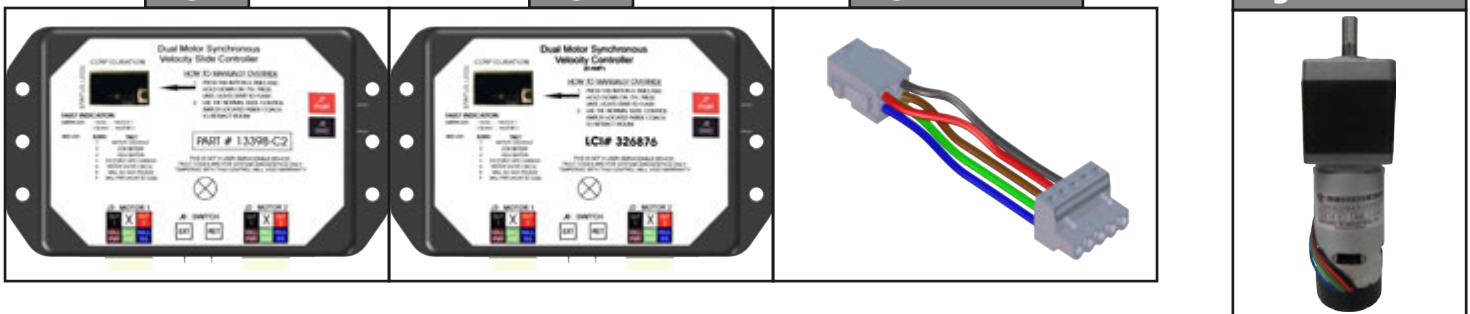

Fig. 5

Fig. 6

Fig. 7 - 258760

Fig. 8 - 229466



NOTE: Ensure that a 300:1 motor is replaced with a 300:1 motor (Fig. 9A), and that a 500:1 motor is replaced with a 500:1 motor (Fig. 9B). The labels on the motors will identify the gear ratio.

Fig. 9A - 236575, 300:1

Fig. 9B - 287298, 500:1

Fig. 10 - Obsolete



This manual has been provided courtesy of
My RV Works, Inc.

www.myrvworks.com



You can find more RV service manuals here:

www.myrvworks.com/manuals

Over the years of running a mobile RV repair service, having a dedicated place to access service manuals for all the different appliances and components found on RVs was something that I always had a desire to create.

I hope this resource makes your RV repairs easier, as it has mine, but please be careful and follow proper safety practices when attempting to repair your own RV.

If in doubt, please consult with a professional RV technician!



DARREN KOEPP - OWNER, MY RV WORKS, INC.

All service manuals provided on www.myrvworks.com are believed to be released for distribution and/or in the public domain.